



# NADEJDA

---

PRICE: 1.450.000€ VAT PAID



## INTRODUCING NADEJDA

---

This Shipman 72, performance sailing yacht NADEJDA is the ultimate lightweight, carbon, luxury cruising yacht for short handed safe and exhilarating sailing in all weather. She is a well proven and meticulously maintained, highly upgraded example of this popular model.

The bright and spacious living area is surrounded by large windows which fill the space with natural light, giving a comfortable and welcoming feel to her open plan layout.

Featuring 3 cabins including a full beam, light filled master suite and 2 convertible guest cabins as well as a large protected cockpit for guests to enjoy the sailing in comfort and safety. Her highly innovative features are unparalleled on this size of performance yacht. Everything has been thought of making this the ultimate fast cruising machine.





*Vadejda*

London





## EXCEPTIONAL SAILING PERFORMANCE

---

NADEJDA is a lightweight yacht with a full carbon composite hull, rig and rigging making her extremely fast and maneuverable but also comfortable and suitable for minimal crew handling. She has always been run by a full time Captain and 1 crew member. Her hydraulically lifting, deep draft, fin keel and twin carbon rudders along with a retractable carbon bowsprit mean versatile and exciting performance in all conditions and wind strengths. She has a brand new suite of Doyle Stratis, Carbon sails giving her even more performance.

Laden with top quality hardware, Hall spars Carbon Mast and Boom and EC6 Carbon rigging and Harken winches giving race-proven technology above deck, as well as an

abundance of space and luxury below, she has proven to be a truly impressive performance sailor's yacht in every respect. She performs equally well gliding along in light, Med winds as well as flying down ocean swells in the Atlantic in heavy conditions, eating the miles off passages with ease.

As a racer, NADEJDA has participated twice in the Rolex Middle Sea Race proving her offshore racing capabilities.











## THE DECK

---

Forward there is a large sail locker in the bow which accommodates the cruising Gennaker, flying 'Code 0' as well as the Staysail and Storm jib along with numerous sheets and halyards, fenders and water sports equipment. This can be accessed from the crew accommodation by a watertight door as well as the deck hatch.

Heading aft on deck to the cockpit finds a central teak table with lifting side leafs and a top opening drinks fridge surrounded on either side by comfortable sofa seating for 6 guests. Here you are well protected by the cockpit comings and foldable spray dodger and safe from all sailing systems, halyards and sheets which run internally in the cockpit comings.

The mainsheet is centrally positioned aft of the table on the deck and between the twin helm stations.

Twin helm stations offer perfect line of sight for sailing and include B&G Zeus screens and B&G H5000 graphic displays.

Carbon JP3 steering wheels with direct drive, dyneema cables to twin carbon rudders give precise finger tip feeling for sporty sailing.

The aft part of the cockpit has a fully mechanically operated, retractable passarelle which converts to an aft seat while under way enclosing the cockpit for added safety. Once deployed at anchor the passarelle offers access down steps to a large hydraulically operated transom door becoming a huge swimming platform with removable swim ladder. This also allows the easy launch and retrieval of the Zodiac tender.







## THE INTERIOR

---

This is a genuine "deck salon" with newly replaced, tinted wrap around windscreen glass offering views out across the deck to the sea. Above in the deck head there are further opening hatches offering more light and ventilation – also fitted with OceanAir screens. There is storage under the seating area, behind settees, in lockers and under the floor soles.

To port the dining table surrounded by sofa's on all sides easily seats 6 people. The table drops hydraulically and an insertable cushion converts this to a large day berth which is popular at sea and also for watching films on the TV which raises from the bulkhead forward next to the keel box.

Aft, to starboard is the full size navigation station. This has superb vision for watch keeping at sea, and is perfect for passage planning and easily accessible to the deck.

To starboard is the open Galley making it an engaging place to interact in a casual and family environment, with all the equipment required for the chef to produce gourmet meals.



## GUEST ACCOMMODATION

The Owner's stateroom is positioned centrally, immediately forward of the lifting Keel and below the rig allowing for a more comfortable motion at sea and is also very private and peaceful at anchor.

There is a full beam, light filled ensuite bathroom with a toilet, bidet and large walk in shower. To starboard of the large owner's bed is a sofa which can be converted to a single sea berth or children's bed.

A vanity desk forward of the bed as well as plentiful hanging lockers and numerous storage drawers. The cabin is fully air-conditioned.

NADEJDA also features two guest cabins aft which can both be converted from twin singles to doubles, each with their own ensuite bathrooms with heads, basin and separate showers.

## OWNER'S SUITE



OWNER'S SUITE



OWNER'S SUITE







VIP CABIN



TWIN CABIN





## GENERAL ARRANGEMENT

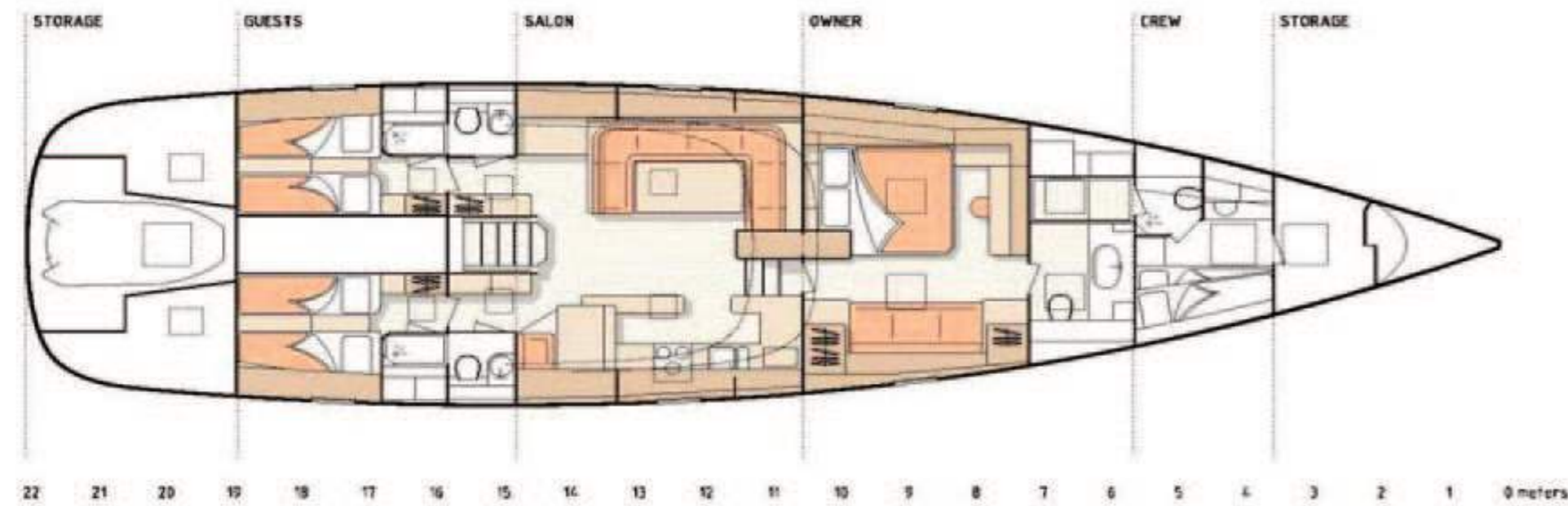

## SPECIFICATIONS

S/Y "NADEJDA" has been consistently upgraded and maintained by a professional and dedicated crew.

### OVERVIEW

BUILDER	/	SHIPMAN
NAVAL ARCHITECT	/	J&J DESIGN, SEAWAY
INTERIOR DESIGNER	/	J&J DESIGN, SEAWAY
YEAR	/	2009

### DIMENSIONS

LENGTH OVERALL	/	21.95M (72')
LENGTH AT WATERLINE	/	20.19M (66'2")
BEAM	/	5.49M (18')
DRAFT (MAX)	/	4M (13'12")

### ACCOMMODATIONS

GUESTS	/	6
CABINS TOTAL	/	3
CREW	/	2

## GENERAL

BUILDER	/	SEAWAY GROUP
MODEL	/	Shipman 72, design Cat "A" ocean
YEAR	/	2009
TYPE	/	Sail Yacht
LENGTH	/	21.95 M (72')
LENGTH AT WATERLINE	/	20.19 M (66'24")
BEAM	/	5.49 M (18')
DRAFT (MIN)	/	2.60 M (8'53")
DRAFT (MAX)	/	4.00 M (13'12")
MAX HEIGHT ABOVE WATERLINE	/	33.20 M (108'92")
DISPLACEMENT (LOADED)	/	29.07 tons
NAVAL ARCHITECT	/	J&J Design, Seaway
INTERIOR DESIGNER	/	J&J Design, Seaway

## CAPACITIES

FUEL CAPACITY	/	2 x tanks of 1,250 L and 250 L (1,500 L / 396,26 USG)
WATER CAPACITY	/	2 x 800 L tanks (1,600 L / 422,67 USG)
BLACK WATER CAPACITY	/	4 x 50 L tanks (200 L / 52.83 USG)
RANGE	/	400 nm at 2,500 rpm and at 25 L/h at 8 kn

## CONSTRUCTION

HULL MATERIAL	/	Carbon composite
SUPERSTRUCTURE	/	Carbon composite
DECK MATERIAL	/	Teak

## ACCOMMODATIONS

GUESTS	/	6 in 3 cabins
CREW	/	2 in 1 cabin

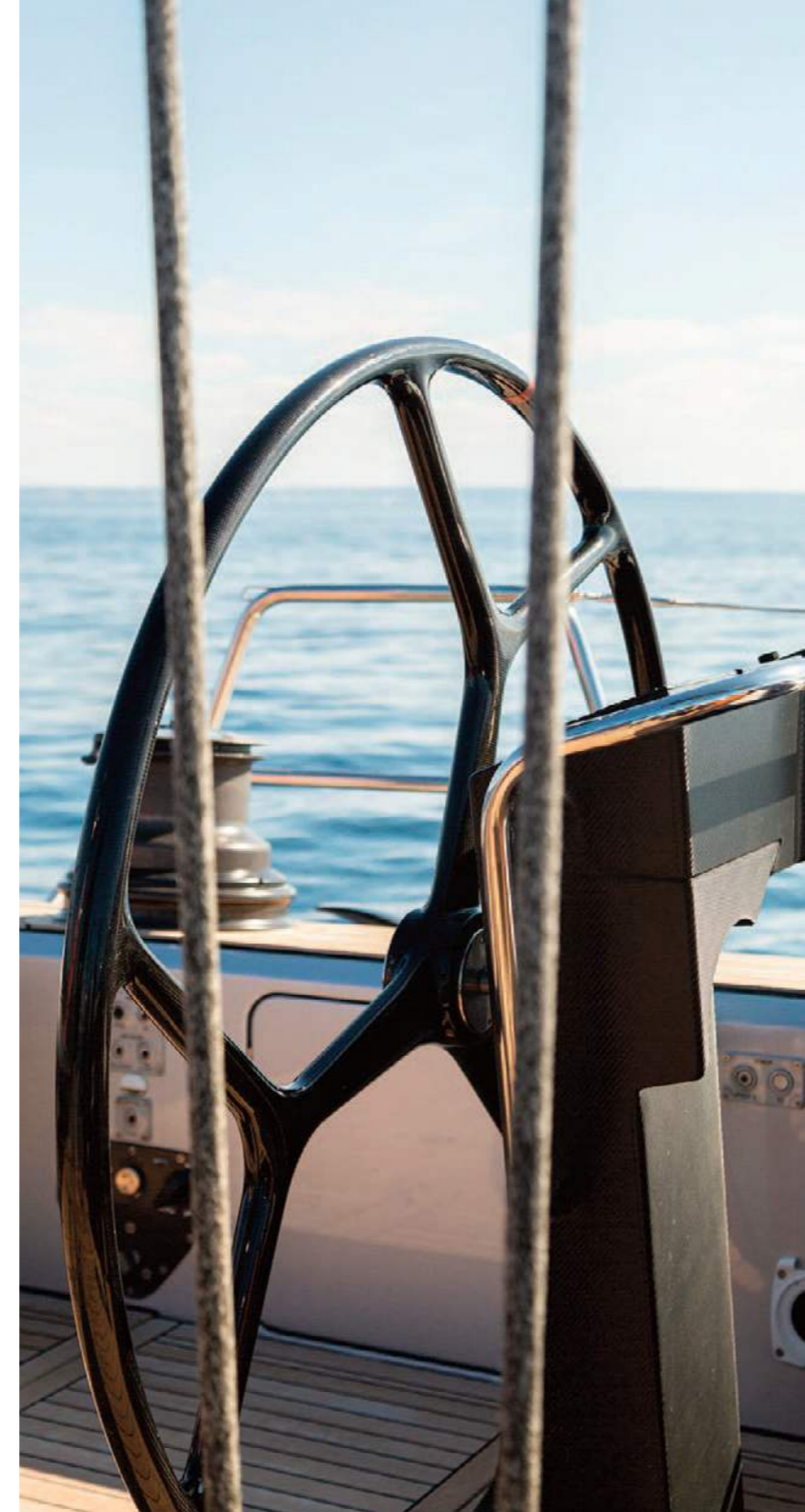

## MACHINERY

ENGINES	/	1 x Yanmar 4LHA-STP 250hp
GENERATORS	/	1 x Onan MDKDP 13.5kw
SERVICE BATTERIES & CHARGERS	/	New Odyssey PC1800-FT. Service battery Bank
	/	Mastervolt chargers for service, main, radio, Generator
	/	Mastervolt inverters
PROPULSION & STEERING	/	2 x Jp3 Carbon Fibre steering wheels with direct chain and cable (Dynema)
	/	B&G rudder angle indicator incorporated into the B&G H5000 system
ELECTRICAL SYSTEM	/	Max Power bow thruster
	/	220v electrical system
	/	1 x 220 V single socket Crew Cabin
	/	1 x 220 V single socket Master Head
	/	3 x 220 V double socket Master Cabin
	/	2 x 220 V double socket Main Saloon
	/	2 x 220 V double socket Galley
	/	1 x 220 V double socket Port Guest
	/	1 x 220 V single socket Port Guest Head
	/	1 x 220 V double socket Stbd Guest
	/	1 x 220 V single socket Stbd Guest
ALTERNATOR	/	12 V standard alternator for engine and generator batteries which can be paralleled
SHORE POWER	/	24 V Mastervolt 150 amp for service batteries
	/	2 x 32 amp cables from stbd side split between air con and charges for smaller ports with low power



- FRESH WATER & HEATING SYSTEM / 50 L hot water tank with 220v immersion heater as well as glycol loop to Main Engine heat exchanger.
- / Fresh drinking water tap in galley by Myro 7
  - / Single freshwater pump Jabsco
- WATER MAKER / Zen 150 producing 150 L/h
- BILGE PUMPS / 7 x Bilge pumps with alarms and auto float switch also manual switching at breaker board
- AC UNIT / 3 X 8000 BTU fan coils location in crew cabin and both guest cabins, all interchangeable should one break. Individual control panel per unit in cabin. Heating and cooling
- / 3 x 12000 BTU fan coils in location master, galley and main saloon. All interchangeable. Master cabin single control unit for one unit, galley and saloon have a single control unit.
  - / 2 x 50000 Btu frequency chiller units Port and starboard lazaretto allowing for lower power consumption than compressors. One chiller unit can run entire system on its own, two units allow for a backup and shared load system. Glkycol system

**RIGGING & SAILS MEASUREMENTS**

- / J : 9.04 M
- / I : 27.56 M
- / E : 8.85 M
- / P : 27.45 M
- / Mainsail area : 142 m
- / Jib Area : 120 m
- / Flying Code o : 230 m
- / Asymmetric Spinnaker : 390 m

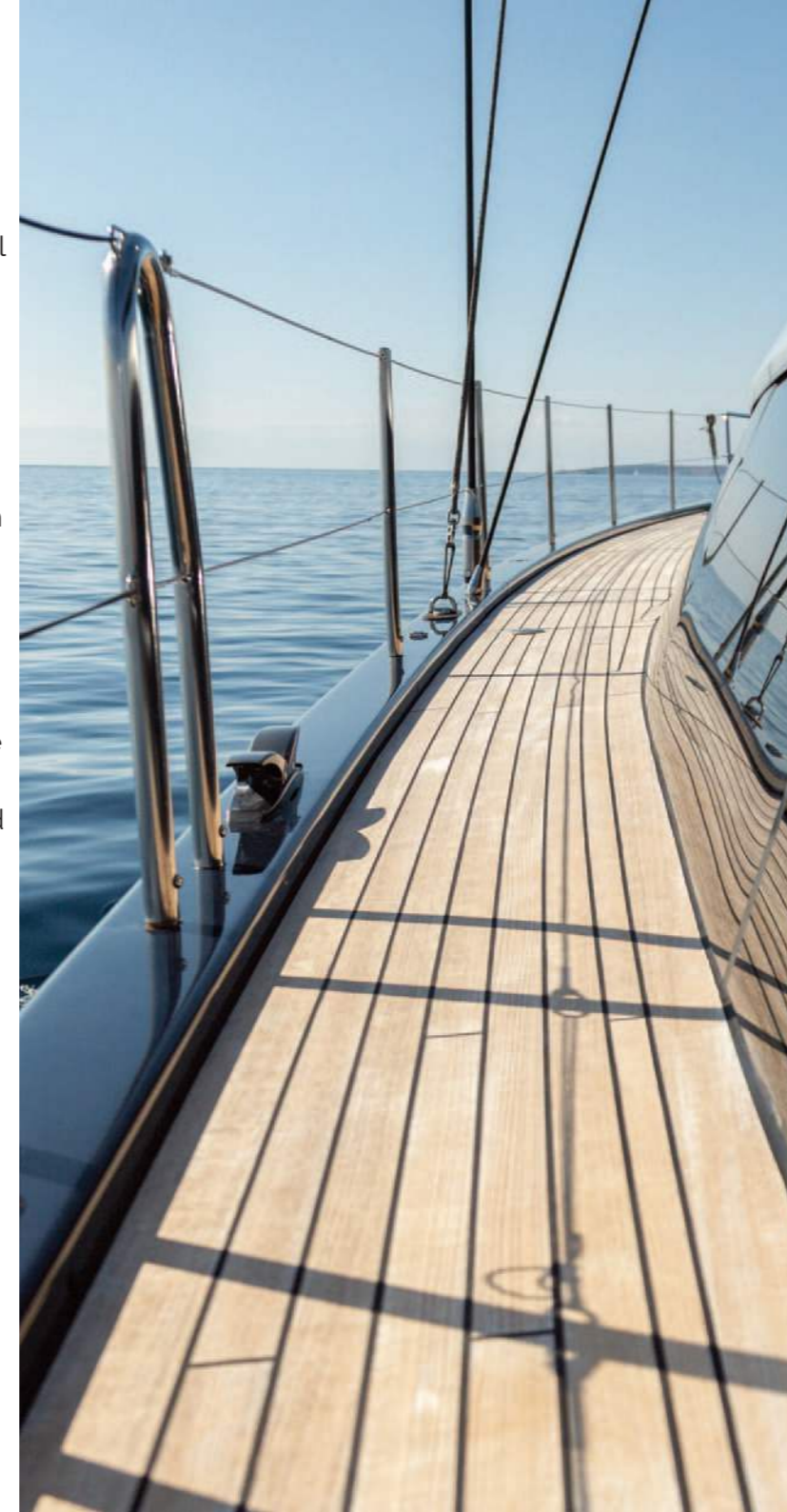

- RIG / Hall spars Carbon Fibre mast
- / EC6 rigging
  - / Mast ram fitted inside with Jack
  - / Reckman hydraulic jib furling unit reconditioned by Reckman
  - / Hall spars Boom Carbon park avenue boom with lazy jacks
- SAILS / Doyle Stratis Brand Full pattern Main
- / Doyle Stratis Brand Furling vertical pattern jib
  - / Furling inner jib
  - / Doyle cruising Gennaker with inflatable bucket Storm Jib
- SAILS DIMENSIONS / 1 x Doyle Stratis MainSail : 137.8 sqm
- / 1 x Doyle Stratis Blade jib: 124.23 sqm
  - / 1 x Doyle Superkote 200Gennaker: 415.97 sqm

**NAVIGATION EQUIPMENT**

- Equipment / 2 x B&G Zeus 9"
- / Navionics card SD XL9
  - / B&G Zeus MFD 12" Halo 20 + Radar
  - / B&G Radar cerrado Halo 20
  - / B&G multifunction zeus 12 MFD
  - / 3 x B&G Nemesis 12"
  - / B&G Nemesis Hub
  - / 3 x B&G H5000 Graphic Display
  - / B&G NMEA KIT
  - / B&G Smart Transducer
  - / B&G Precision 9 Compass
  - / B&G pilot computer H5000
  - / B&G Rudder reference NMEA 2000
  - / 2 x B&G VHF D V100 AIS Transponder



## INTERIOR EQUIPMENT

### GALLEY EQUIPMENT

- / Force 10 gas oven and 4 burners on gimbal
- / 1 x Isotherm fridge with freezer unit 100lt air cooled unit built in, front opening
- / 1 x Stainless steel fridge fitted 100lt with separate air cooled unit, front opening
- / 1 x Freezer water cooled 75 lt top opening
- / 1 x Nespresso coffee machine
- / 1 x 800w microwave fitted with grill option
- / Stainless extractor with run silent fan

### HEADS EQUIPMENT

- / 4 x Heads with built in macerator and electric flush function (master with slow close)
- / Bidet in master cabin with fresh water

## DECK EQUIPMENT

### WINCHES

- / 4 x Harken 990 hydraulic
- / 1 x Harken 2 speed mast winch
- / 1 x Sanguiniti retractable mooring winch on bow

### PASSERELLE

- / Hydraulic passerelle swing away fully retractable

### SWIMMING PLATFORM

- / Swim platform fully hydraulic plus stainless swim ladder with teak steps

### ANCHORING

- / Maxwell hydraulic windlass
- / Retractable anchor arm made of carbon fibre

### COVERS, CANVAS & CUSHIONS

- / Boom tent awning in Black with easy stowage System
- / Dodger in grey, stores flush with deck with clear forward facing sections great condition
- / Aft Bimini in grey shade over helms and rear bench seat
- / Covers for all winches, helms, wheels, exterior cushions for condensation at night

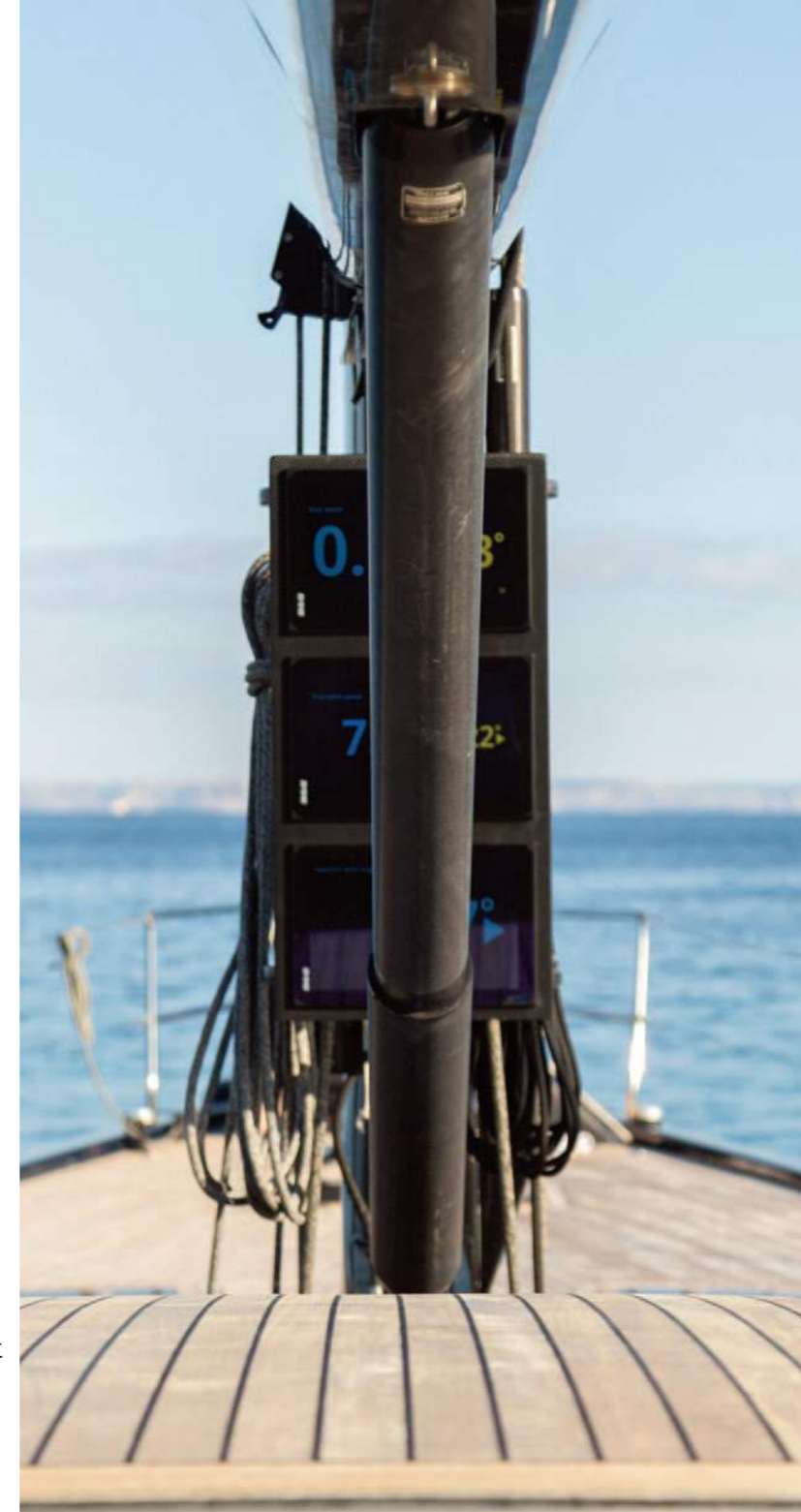

## TENDERS & TOYS

### TENDER

- / 1 x Zodiac Cadet 310 tender with a 9.9 Mercury 4 stroke outboard engine easily stowed from transom door inside tender garage

## SAFETY EQUIPMENT

### LIFE JACKETS

- / 6 x Life jackets

### GRAB BAGS

- / 2 x Grab bags

### LIFE RAFTS

- / 1 x 8 persons liferaft

### OTHER EQUIPMENT

- / 1 x Jon Bout

- / 1 x EPIRB

- / 9 x Flares

### FIRE EXTINGUISHERS

- / Fire extinguisher in each cabin

### FIRE BLANKET

- / 1 x fireblanket for galley

### OTHER FIRE FIGHTING EQUIPMENT

- / Manual gas fire system for engine room

- / Smoke detector in cabins and lazaretto battery power



## REFITS

### 2019/2020

GALLEY / Force 10 gas oven and 4 burners on gimbal

### 2020/2021

KEEL & RUDDER / Twin JP3 rudders in full Fibre. Top and bottom bearings

BOWSPRIT / Hydraulic lifting keel with 3 rams operating, two locking and one lifting

HULL & DECK / Carbon Fibre with manual retrieval line

/ New bobstay Dynema with cover and elasti retrieval

/ Carbon Fibre foam sandwich

/ Fully laid teak deck

/ Full replacement wrap around windscreen glass and deck hatch glass

ENGINE AND GEARBOX / Main engine 1 x Yanmar 4LHA-STP only 642 Hours

/ Generator 1 x Onan MDKDP 13.5kw brand new upgraded from original size to allow for lithium iron powere watersports toys charging,currently at 2043 hours

/ Engine room rebuild all new fuel lines and exhaust system, forced ventilation new, shaft seal, engine mounts, exhaust box, through hull valves

/ Complete rebuild of vibration and sound insulation

COVERS, CANVA & CUSHIONS / Aft Bimini in grey shade over helms and rear bench seat

/ Exterior cushions

### 2021/2022

SERVICE BATTERIES & CHARGERS / New Odyssey PC1800-FT. Service battery Bank

/ Extra Mastervolt charger added to reduce hours put on generator

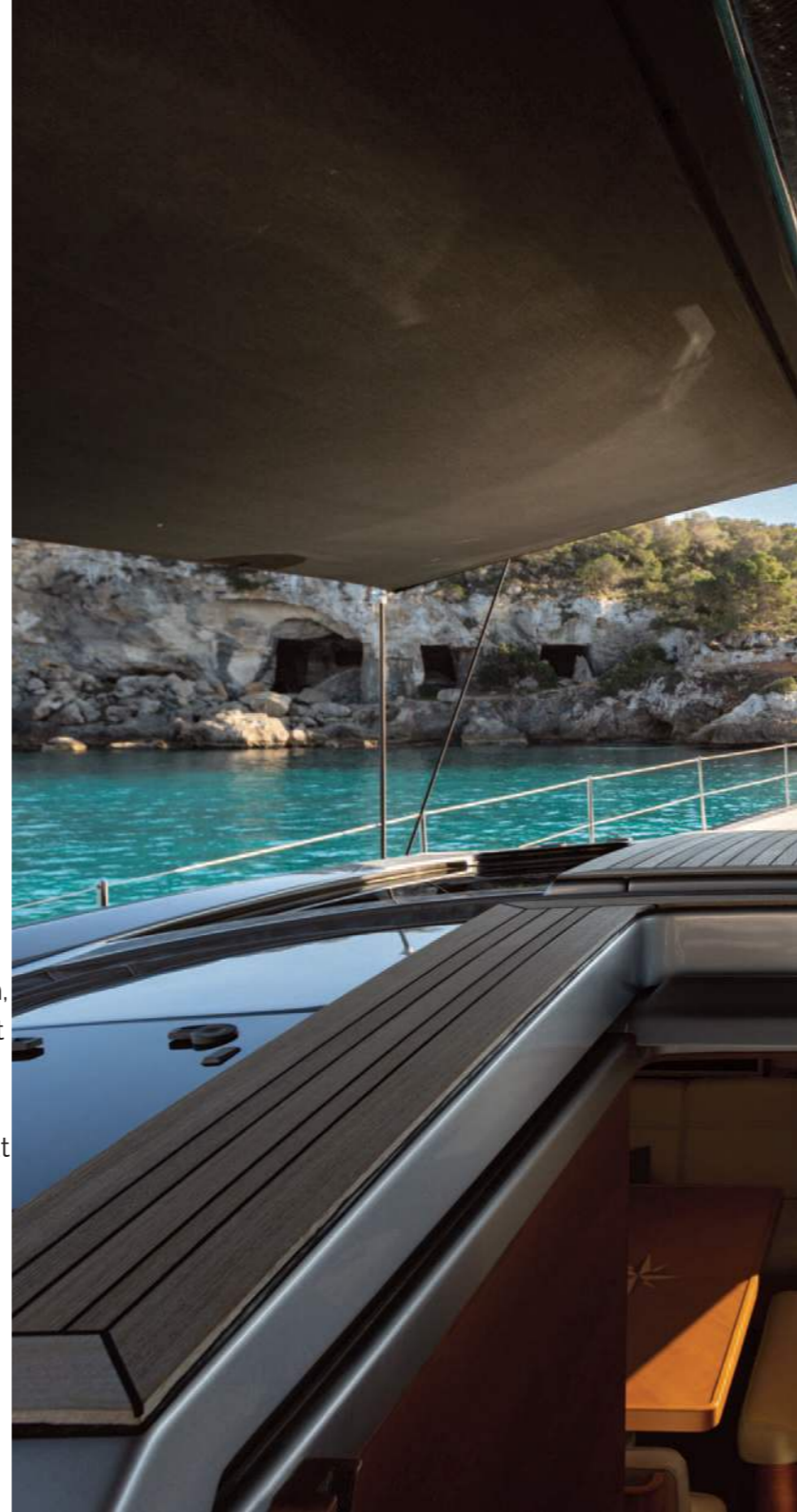

PROPULSION & STEERING / Mastervolt Easyview touch screen fitted

WATER MAKER / Max Power bow thruster

FUEL SYSTEM / Water maker zen 150 producing 150 L/h

HEATING / AC SYSTEM / Tanks inspection hatch seals replaced

RIG / Entire system replaced

/ Reckman hydraulic jib furling unit reconditioned by reckman

SAILS / Doyle cruising Gennaker 2022 with inflatable bucket

WINCHES / Sanguiniti retractable mooring winch on bow

COVERS, CANVS & CUSHIONS / Boom tent awning in Black with easy stowage system

/ Leather cushions for all interior

Other / Washer/Dryer in owners head

### 2022/2023

RIG / Mast ram fitted inside with Jack

SAILS / Doyle Stratis Brand Full pattern Main

/ Doyle Stratis Brand Furling vertical pattern jib





